

●

High speed optional A3 Flatbed scanner.

Perfect for
scanning bound
and fragile
media.



High performance boosts productivity

Canon's A3 Flatbed scanner offers high speed scanning at up to 3.5 seconds. Connect the device to a DR-scanner and you can enjoy high speed batch scanning alongside fast A3 Flatbed scanning - saving time and improving productivity.

Versatile media handling

Scan a wide range of media including books, ledgers and fragile documents - perfect for government offices, libraries, the construction industry and general office departments.

Extend the power of your DR-scanner

Optimise both ADF and flatbed capture in a seamless scanning operation. Scan in multiple formats into a single document file and send directly to various output destinations including email, folders and popular data management applications with ease.

Outstanding features and benefits include:

- High performance A3 Flatbed scanner
- Rapid scanning speeds
- Simple USB connection with imageFORMULA scanners
- Seamless dual scanning, single file operation
- Includes unique ambient light cancelling mode
- Access to the DR-scanner's powerful image processing features
- Perfect for capturing bound and fragile documents
- Compact and robust design ideal for demanding environments

Specifications: Flatbed Scanner Unit 201



Type	Universal A3 Flatbed Scanner Option
Document Reading Sensor	CCD Sensor
Optical Resolution	600 dpi
Light Source	LED (RGB)
Reading Side	Front
Interface	High speed USB 2.0
Dimensions	Tray Closed: 571 (W) x 436 (D) x 96 (H) mm
Weight	Approx. 8.5 Kg (Without AC Adaptor)
Power Requirements	AC100 - 240V (50 / 60Hz)
Power Consumption	Scanning 21W or less, Sleep Mode 3.1W or less, Power Turned Off, less than 0.3W
Operating Environment	10 - 32.5°C (50 - 90.5°F), Humidity: 20 - 80% RH
Environmental Compliance	RoHS and ENERGY STAR*

DOCUMENT SPECIFICATIONS

Width	297.4 mm
Length	431.8mm

OUTPUT

Mode	Black and White, Error Diffusion, Advanced Text Enhancement II, 8-bit Greyscale (256-level), 24-bit Colour, Auto Colour Detection
Resolution	100 x 100 dpi, 150 x 150 dpi, 200 x 200 dpi, 240 x 240 dpi, 300 x 300 dpi, 400 x 400 dpi, 600 x 600 dpi

PRODUCT FEATURES

Automatic Page Size Detection, Deskew, Ambient Light Cancelling Mode, Scan Area Setting, Scanning side, Contrast Arrangements, Automatic Resolution Setting. Features inherited from DR-scanners: Auto Colour Detection, Text Orientation Recognition, Moire Reduction, Edge Enhancement, Prevent Bleed Through / Remove Background, Preset Gamma Curve, Colour Dropout / Colour Enhancement, MultiStream, Barcode Recognition.

Some images are simulated for clarity of reproduction. All data is based on Canon's standard testing methods. This leaflet and the specifications of the product have been developed prior to the date of product launch. Final specifications are subject to change without notice.™ and ®: All company and / or product names are trademarks and / or registered trademarks of their respective manufacturers in their markets and / or countries.

READING SPEED

(A4, Portrait)

Flatbed Scanner Unit 201

B&W / Greyscale	200 / 300 dpi	A4 3.0 seconds	A3 3.5 seconds
Colour	200 / 300 dpi	3.5 seconds	4.5 seconds

Compatible DR-Series Scanners

imageFORMULA DR-C225
imageFORMULA DR-C130
imageFORMULA DR-C240

imageFORMULA DR-M140
imageFORMULA DR-M160II
imageFORMULA DR-M1060

imageFORMULA DR-6010C
imageFORMULA DR-6030C

imageFORMULA DR-G1100
imageFORMULA DR-G1130

imageFORMULA DR-X10C

Connectivity Diagram

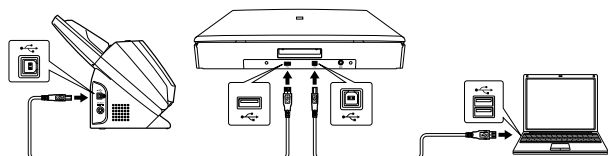

When using the DR scanner that uses an AC adaptor, Flatbed Scanner Unit 201 is connected between DR scanner and PC

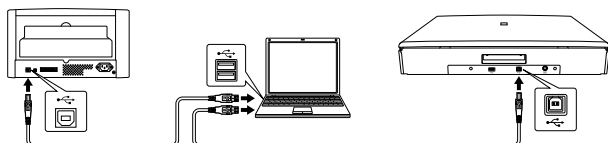

When using the DR scanner that has power built-in, connect both Flatbed Scanner Unit 201 and DR scanner directly to the PC



Canon Electronics Inc
canon.com

Canon Europe
canon-europe.com

English Edition
© Canon Europa N.V., 2015

Canon Europe Ltd
3 The Square
Stockley Park
Uxbridge
Middlesex
UB11 1ET
United Kingdom