

imageRUNNER C3025

COLOUR A3 ALL-IN-ONE FOR BUSINESSES THAT DEMAND PRODUCTIVITY, QUALITY AND VALUE.

A colour A3 multifunctional that's easy to use and ideal for reducing the administrative costs related to printing - a complete end-to-end document workflow solution for any office.



Assured Canon quality

The imageRUNNER C3025 is a colour A3 multifunctional offering a fast 25 pages per minute print speed and thanks to key technologies it becomes a valuable asset to any working environment all in a compact freestanding, offering. Canon's V² (Vivid & Vibrant) imaging technology ensures documents truly stand out from the crowd and the responsive 12.7 cm (5") colour touch interface delivers a quick and easy user experience. Thanks to mobile printing and scanning capabilities including Apple AirPrint™ and Mopria printing it not only supports new ways of working but promotes it.

Print Management made easy

Universal Login Manager (ULM) is designed to protect and optimise your device by providing simple, yet secure, user authentication options for device access control. ULM allows for print permissions to be established for users and delivers personalised workflows to drive productivity. In addition, simple reporting tools provide a powerful business insight into device and user activity and costs. Activation is required.

Control the total cost of print

Easy device management means a reduction in administrative costs for IT teams thanks to less time and effort needed to maintain the device, with automated meter collection, consumables management and remote diagnostics. Thanks to embedded support for Canon's uniFLOW software the imageRUNNER C3025 easily integrates as part of a larger fleet, letting you track and charge individual print jobs to people, locations, departments and projects, as well as providing per-user reports.



PRINT



COPY



FAX
Optional



SCAN

Canon

Fits any office environment

The imageRUNNER C3025's size and power make it a small but mighty document solution ideal for small workgroups within organisations of any size. Workflow integration, productivity and the option of 3-in-1 staple finishing are all available within the device's compact freestanding footprint, while adding the device to existing ecosystems is made simple with support for standards such as PCL and optional Genuine Adobe PS. Security is a priority in any modern working environment, ensure your information remains confidential with secure print, pin release and PDF password protection, plus optional uniFLOW adds further levels of security around your office eco-system.

Energy efficient

This ENERGY STAR® qualified device offers a class-leading TEC* rating and consumes just 1W or less in sleep mode. It is designed to be more energy efficient, reducing power consumption while in use and keeping its environmental impact to a minimum. The imageRUNNER C3025 demonstrates strong environmental credentials by also qualifying for the stringent Blue Angel award.

* Typical Energy Consumption. Methodology defined by ENERGY STAR (www.eu-energystar.org)

Configuration

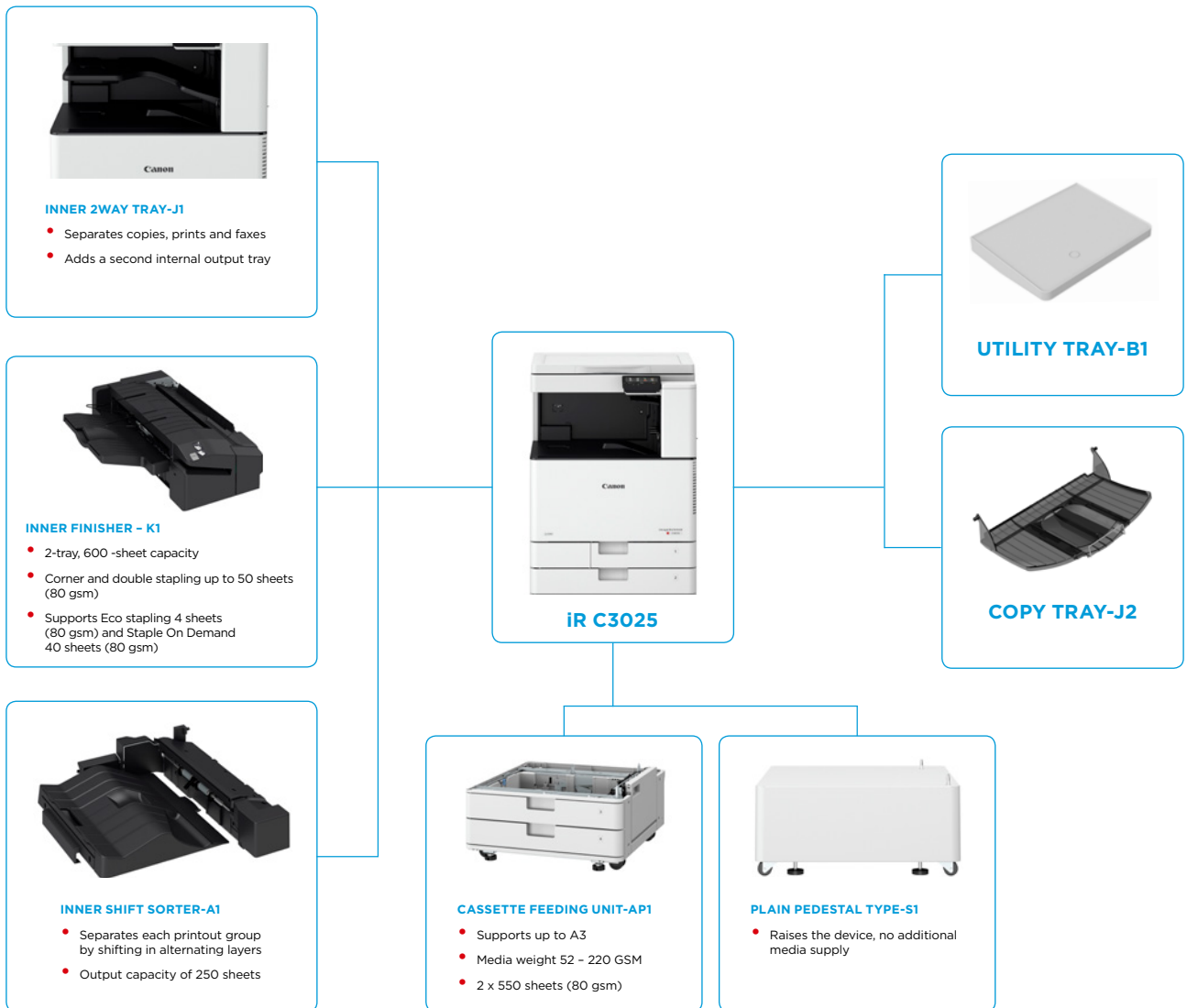

TECHNICAL SPECIFICATIONS

imageRUNNER C3025

MAIN UNIT		PRINT SPECIFICATIONS	
Machine type	Colour Laser Multifunctional	Printing method	Colour Laser Beam Printing
Core functions	Print, Copy, Scan, Send and Optional Fax	Print Speed (BW/CL)	25 ppm (A4), 15 ppm (A3), 20 ppm (A4R), 25 ppm (A5R)
Processor Speed	Canon Dual Custom Processor (Shared) 800 MHz	Print Resolution	600dpi×600dpi, 1200dpi×1200dpi
Control Panel	12.7 cm (5 inch) TFT LCD WVGA Colour Touch panel	Page description languages	UFR II, PCL 6 (Standard), Genuine Adobe PostScript Level 3 (Optional)
Memory	Standard: 2.0GB RAM	Double Sided Printing	Automatic (Standard)
Interface Connection	NETWORK Standard: 1000Base-T/100Base-TX/10Base-T, Wireless LAN (IEEE 802.11 b/g/n); Optional: NFC	Direct Print	Direct printing available from USB memory key Supported file types: TIFF, JPEG, PDF and XPS* XPS is supported from LPR command print.
	OTHERS Standard: USB 2.0 (Host) x2, USB 2.0 (Device) x1; Optional: Copy Control Interface	Printing from mobile and cloud	A range of software is available to provide printing from mobile devices or internet-connected devices and cloud-based services depending on your requirements. Please contact your sales representative for further information
Network Protocols	TCP/IP, Frame type: Ethernet II Print applications: LPD/Raw/IPP/PPS/FTP/WSD/Mopria/GCP/AirPrint/Windows10 Mobile Print	Fonts	PCL fonts: 93 Roman, 10 Bitmap fonts, 2 OCR fonts, Barcode fonts* PS fonts: 136 Roman *Requires optional BARCODE PRINTING KIT-D1
Paper Input (Standard)	2 x 550-sheet cassettes (80gsm) 100-sheet multi-purpose tray (80gsm)	Operating System	UFR II: Windows Vista/Server 2008/Windows 7/Server 2008 R2/Windows 8/Server 2012/Windows 8.1/Server 2012 R2/Windows 10/Server 2016, MAC OS X (10.7.5 or later), Linux PCL: Windows Vista/Server 2008/Windows 7/Server 2008 R2/Windows 8/Server 2012/Windows 8.1/Server 2012 R2/Windows 10/Server 2016 PS: Windows Vista/Server 2008/Windows 7/Server 2008 R2/Windows 8/Server 2012/Windows 8.1/Server 2012 R2/Windows 10/Server 2016, MAC OS X (10.7.5 or later) PPD: MAC OS 9.1 or later, MAC OS X (10.3.9 or later), Windows Vista/Windows 7/Windows 8/Windows10 SAP Device Types are available via the SAP Market Place. Please refer to http://www.canon-europe.com/support/businessproduct-support for availability of print solutions for other operating systems and environments including AS/400, UNIX, Linux and Citrix. Some of these solutions are chargeable.
Paper Input (Option)	2 x 550-sheet cassettes (CASSETTE FEEDING UNIT-API)		
Maximum Paper Input Capacity	2,300 sheets (80 gsm)		
Paper output capacity	Without Finisher: 250 sheets (A4, 80 gsm) With Inner Finisher: Max. 600 sheets (A4, 80 gsm)		
Finishing capabilities	Collate, Group With Inner Shift Sorter: Collate, Group, Offset With Inner Finisher: Collate, Group, Offset, Staple, Staple-Free Staple, Staple on Demand		
Supported media types	Cassettes 1/2: Thin paper, Plain paper, Thick paper, Colour paper, Recycled paper, Pre-punched paper, Transparency, Bond paper, Envelope Multi-purpose tray: Thin paper, Plain paper, Thick paper, Colour paper, Recycled paper, Pre-punched paper, Transparency, Bond paper, Envelope, Label, Tracing paper, Coated paper Cassette 3/4 (CASSETTE FEEDING UNIT-API): Thin paper, Plain paper, Thick paper, Colour paper, Recycled paper, Pre-punched paper, Transparency, Bond paper		
Supported media sizes	Cassette 1: Standard size: A4, B5, A5R Envelopes: No.10 (COM10), ISO-C5, DL Custom Size: 139.7 mm x 182 mm to 297 mm x 215.9 mm Cassette 2: Standard size: A3, B4, A4, B5, A4R, A5R Envelopes: No.10 (COM10), Monarch, DL Custom Size: 139.7 mm x 182 mm to 304.8 x 457.2 mm Multi-purpose tray: Standard size: A3, B4, A4, A4R, B5R, B5, A5, A5R, SRA3 Custom size: 98.4 mm x 139.7 mm to 320 mm x 457.2 mm Envelopes: No.10 (COM10), Monarch, ISO-C5, DL CASSETTE FEEDING UNIT-API: A3, B4, A4, A4R, B5R, B5, A5R Custom Size: 139.7 mm x 182 mm to 304.8 mm x 457.2 mm	COPY SPECIFICATIONS	
Supported media weights	Cassette 1/2: 52 to 220 gsm Multi-purpose tray: 52 to 300 gsm Cassette Feeding Unit-API: 52 to 220 gsm	Copy Speed (BW/CL)	25 ppm (A4), 15 ppm (A3), 20 ppm (A4R), 25 ppm (A5R)
Warm-up Time	From Power On: 30 Seconds or Less ¹ From Sleep Mode: 10 Seconds or Less	First-Copy-Out Time (BW/CL)	Approx. 5.9/8.2 seconds or less
Dimensions (H x W x D)	777 mm x 565 mm x 635 mm	Copy resolution	Reading: 600 dpi x 600 dpi Printing: 600 dpi x 600 dpi
Installation Space (W x D)	978 mm x 1,088 mm (Basic: Platen cover + Multi-purpose tray extension extended + Cassette open) 1,110 mm x 1,088 mm (Fully Configured: Platen cover + INNER FINISHER-K1 + Multi-purpose tray extension extended + Cassette open)	Multiple Copies	Up to 999 copies
Weight	Approx. 61.2 kg including toner	Copy Exposure	Automatic or Manual (6 Levels)
		Magnification	25% - 400% (1% Increments)
		Preset Reductions	25%, 50%, 71%, 100%
		Preset Enlargements	141%, 200%, 400%
		SCAN SPECIFICATIONS	
		Standard type	Reader and Colour Platen
		Supported media size/s	A3, B4, A4, A4R, B5, B5R, A5, A5R, B6
		Pull Scan Specifications	Colour Network ScanGear2. For both TWAIN and WIA Supported OS: Windows Vista/7/8/8.1/10
		Scan Resolution	204 x 196 dpi, 300 x 300 dpi
		Acceptable Originals/weights	Platen media size: Sheet, Book, 3-Dimensional Objects (Up to 2kg)
		Scan Method	Send functionality available Scan to USB Memory Key available TWAIN/WIA Pull scanning available
		SEND SPECIFICATIONS	
		Optional/ standard	Standard
		Destination	E-mail/Internet FAX (SMTP), SMB, FTP, Super G3 FAX(Optional)
		Colour Mode	Auto Colour Select (Full Colour, Grayscale), Auto Colour Select (Full Colour/ Black-and-White) Full Colour, Grayscale, and Black-and-White
		Address Book/Speed dials	LDAP (50)/Local (300)/Speed dial (281)
		Send resolution	204 x 196 dpi, 300 x 300 dpi
		Communication protocol	File: FTP, SMB v3.0 E-mail/I-Fax: SMTP, POP3, I-Fax (Simple)
		File Format	Standard: TIFF, JPEG, PDF(Compact, Searchable) Optional: PDF(Encrypted, Digital Signature)

TECHNICAL SPECIFICATIONS

imageRUNNER C3025

FAX SPECIFICATIONS

Optional/ standard	Optional
Maximum Number of Connection Lines	1
Modem Speed	Super G3: 33.6 kbps G3: 14.4 kbps
Compression Method	MH, MR, MMR, JBIG
Resolution	400 x 400 dpi, 200 x 400 dpi, 200 x 200 dpi, 200 x 100 dpi
Sending/Recording Size	A5* and A5R* to A3 *Sent as A4
FAX memory	Up to 512 pages
Speed dials	Max. 281
Group dials/destinations	Max. 299 dials
Sequential broadcast	Max. 310 addresses
Memory backup	Yes

SECURITY SPECIFICATIONS

Authentication	<u>Standard:</u> Department ID Authentication, Universal Login Manager
Network	<u>Standard:</u> IP/Mac Address Filtering, IPSEC, TLS Encrypted Communication, SNMP V3.0, IEEE 802.1X, IPv6, SMTP Authentication, POP Authentication before SMTP
Document	<u>Standard:</u> Secure Print <u>Optional:</u> Encrypted PDF, Device signatures

ENVIRONMENTAL SPECIFICATIONS

Operating Environment	Temperature: 10 to 30 °C (50 to 86 °F) Humidity: 20 to 80 % RH (no condensation)
Power source	220-240 V (±10 %), 50/60 Hz (±2 Hz), 4.0 Amp
Power consumption	Maximum: Approx. 1.5 kW Printing: Approx. 407.8 Wh or less ² Standby: Approx. 33.6 Wh Sleep mode: Approx. 2 W Plugin Off: Approx. 0.1 W ² Typical Electricity Consumption (TEC) rating ³ : 0.9 kWh Lot 26 (http://www.canon-europe.com/For_Work/Lot26/index.aspx)

Noise levels (BW/CL)

Sound Power Level (LwAd)⁴
Active(BW): 64 dB or Less², Active(CL): 63.9 dB or Less²,
Standby: No noise⁵

Sound Pressure (LpAm)³
Bystander's position:
Active(BW): 47 dB or Less, Active(CL): 48dB or Less,
Standby: 4.7db⁵

Standards

ENERGY STAR® Qualified
Ecomark
Green purchase
Blue Angel

CONSUMABLES

Toner Cartridge/s	C-EXV 54 TONER BK/C/M/Y
Toner (Estimated Yield @ 5% Coverage)	C-EXV 54 TONER BK: 15,500 pages C-EXV 54 TONER C/M/Y: 8,500 pages

HARDWARE ACCESSORIES

For full information on options available for the iR C3025, please refer to the specification tables on your local Canon web page

Footnotes

- ^[1] Time from device power-on until 1st print output completes, minus FCOT
- ^[2] Data taken from Blue Angel Certification User Information
- ^[3] Typical Electricity Consumption (TEC) rating represents the typical electricity consumed by a product during 1 week, measured in kilowatt-hours (kWh). The test methodology is defined by Energy Star (<http://www.eu-energystar.org>).
- ^[4] Declared noise emission in accordance with ISO 7779
- ^[5] Data taken from ECO declaration

Software and Solutions



Certifications and compatibility



Canon Inc.
canon.com
Canon Europe
canon-europe.com
English edition
© Canon Europa N.V., 2017

**COLOUR A3 ALL-IN-ONE FOR
BUSINESSES THAT DEMAND
PRODUCTIVITY, QUALITY AND VALUE.**

imageRUNNER C3025

A colour A3 multifunctional that's easy to use and ideal for reducing the administrative costs related to printing – a complete end-to-end document workflow solution for any office.



Sales Start Date: June 2017

PRODUCT DETAILS:

PRODUCT NAME	MERCURY CODE	EAN CODE
imageRUNNER C3025 MFP	1567C006AA	4549292087802

OPTIONAL ACCESSORIES:

PRODUCT NAME	MERCURY CODE	EAN CODE
Network Option		
PS Printer Kit-BK1@E	1635C005AA	N/A
Barcode Printing Kit-D1@E	3999B005AA	N/A
Send PDF Security Feature Set-E1@E	9594B002AA	N/A
NFC Kit-D1	1617C001AA	4549292087970
Send/FAX		
Super G3 FAX Board-AV1	1633C002AA	4549292088182
Paper Supply Option		
Cassette Feeding Unit-AP1	1537C002AA	4549292079562
Canon FL Cassette-BE1	1538C001AA	4549292079654
Canon FL Cassette-BF1	1539C001AA	4549292079678
Plain Pedestal Type-S1	2291C001AA	8714574646879
Output Option		
Inner Finisher-K1	1553C001AA	4549292079739
Copy Tray-J2	8815A003AA	4549292031577
Inner 2way Tray-J1	9611B001AA	4549292031867
Inner Shift Sorter-A1	1542C001AA	4549292079722
Staple-P1	1008B001AB	4960999351100
3 Way Unit-D1	8952B001AA	4549292031898



**COLOUR A3 ALL-IN-ONE FOR
BUSINESSES THAT DEMAND
PRODUCTIVITY, QUALITY AND VALUE.**

imageRUNNER C3025

A colour A3 multifunctional that's easy to use and ideal for reducing the administrative costs related to printing – a complete end-to-end document workflow solution for any office.



OPTIONAL ACCESSORIES:

PRODUCT NAME	MERCURY CODE	EAN CODE
Other Option		
Copy Card Reader-F1	4784B001AA	4960999679686
Copy Card Reader Attachment-H2	9897B002AA	4549292087963
IC Card Reader Attachment-B1	1708C001AA	4549292088274
Copy Control Interface Kit-D1	1640C001AA	4549292088281
Cassette Heater Unit-41	8955B001BA	4549292032192
Utility Tray-B1	0165C001AA	4549292026870
Media Adjustment kit-A1	1148C001AA	4549292059779
DCS- Device Centric Software		
MiCard PLUS for ULM	8418B001AA	8714574592169
UFMifare10CardPack	8418B002AA	8714574592176
UFHID10 CardPack	8418B003AA	8714574592183
Consumables		
C-EXV 54 Toner Black	1394C002AA	4549292080452
C-EXV 54 Toner Cyan	1395C002AA	4549292080445
C-EXV 54 Toner Magenta	1396C002AA	4549292080438
C-EXV 54 Toner Yellow	1397C002AA	4549292080421